



TCSP3020 AND TCSP3021 PEEK TOROIDAL CONDUCTIVITY SENSOR PRODUCT SPECIFICATION SHEET



The Sensorex TCSP toroidal (inductive) conductivity sensors feature a wide measurement range and dependable toroidal technology over the range 0-2000 ms/cm. Resistant to corrosion, coatings and fouling common to contacting conductivity sensors, the TCSP3020 is designed for a trouble-free and long service life.

PEEK (unfilled, polyetheretherketone) is the standard material of construction and has a wide solvent tolerance and temperature stability to 130 degrees C. Sensor features 3/4" MNPT for connection to conduit for submersion mounting or insertion in a bushing for inline mounting. A PT1000 RTD temperature element is built into the sensor for temperature compensation. All TCSP sensor models are available with 10ft or 20ft long 9-conductor cable. Custom lengths are available. Please contact Sensorex for pricing.

Sanitary model coming Fall 2023

Resists coating, corrosion and fouling

Durable PEEK construction

Threaded 3/4" NPT for submersion or inline mounting

Choose from two models

TCSP3020 for use with EX2000RS, TCSMA, or TCSTX

TCSP3021 for use with SSRE remote electronics for direct MODBUS or 4-20 mA output

SPECIFICATIONS

Measuring Range	0-2,000,000 uS/cm
Body Material	PEEK
Max Temperature	130°C
Max Pressure	295 psig
Temperature Compensation	Pt 1000 RTD
Cable Length	9 conductor (6 conductor plus shields) with PTFE jacket; available in standard 10ft or 20ft lengths; custom lengths available on request.
Process Connection	3/4" MNPT

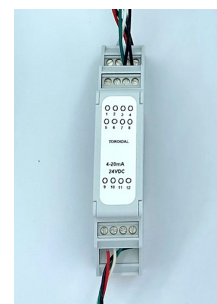

DESIGNED AND ASSEMBLED IN CALIFORNIA, USA

11751 MARKON DRIVE • GARDEN GROVE, CA 92841 • 714.895.4344 • WWW.SENSOREX.COM

© Sensorex Corporation. All rights reserved. In the interest of improving and updating its equipment, Sensorex reserves the right to alter specifications to equipment at any time.

TCSP3020 DIMENSIONAL VIEWS

TCSP3020

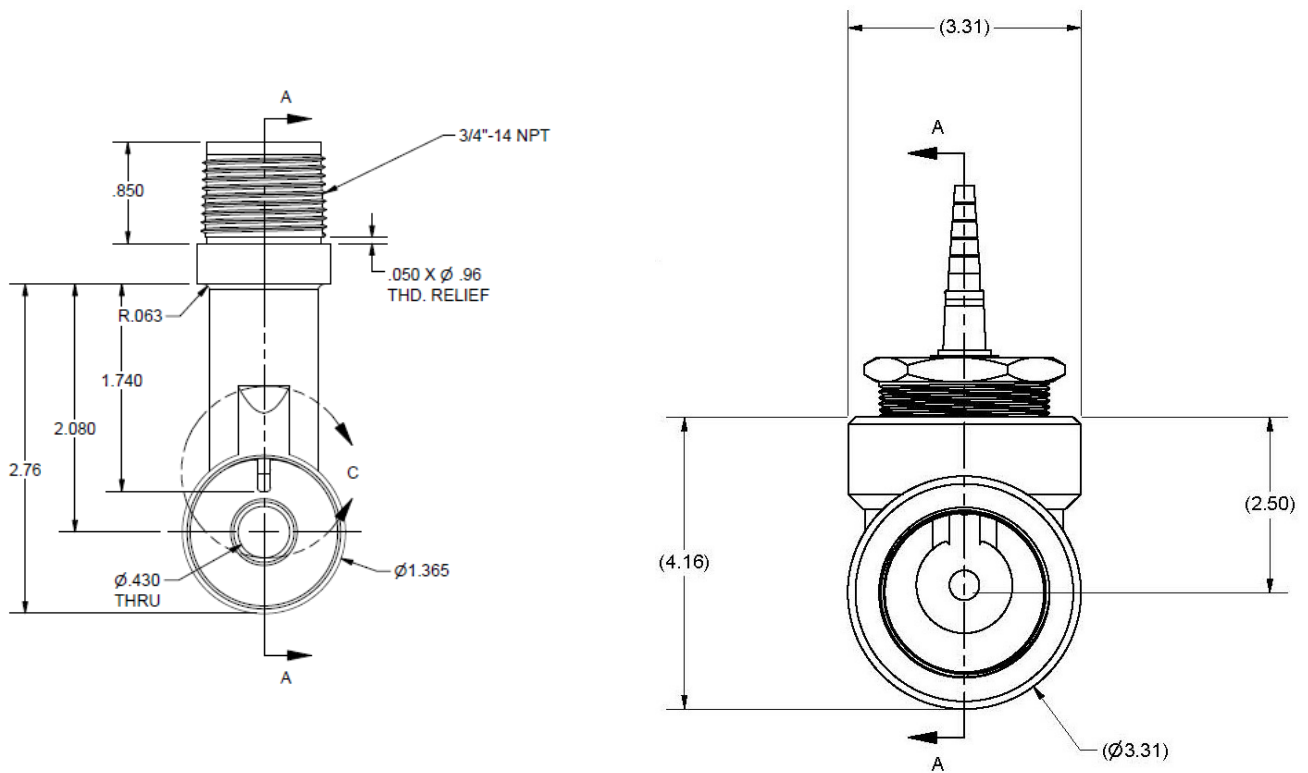

ORDERING INFORMATION

Part Number	Description
TCSP3020-1-CC-3-A-1	PEEK Toroidal Sensor for use with Sensorex transmitters, EX2000RS, TCSMA, TCSTX, 10-ft cable, 3/4 NPT
TCSP3020-1-CD-3-A-1	PEEK Toroidal Sensor for use with Sensorex transmitters, EX2000RS, TCSMA, TCSTX, 20-ft cable, 3/4 NPT
TCPS3021-1-CC-3-A-1	PEEK Toroidal Sensor for use with Sensorex SSRE remote electronics, 10-ft cable, 3/4 NPT
TCSP3021-1-CD-3-A-1	PEEK Toroidal Sensor for use with Sensorex SSRE remote electronics, 20-ft cable, 3/4 NPT
FC900B	Bushing, 3/4" NPT(F) to 2"NPT(M), 304 SS
FC900T	Tee Fitting, 3"NPT(F), 304 SS

DESIGNED AND ASSEMBLED IN CALIFORNIA, USA

11751 MARKON DRIVE • GARDEN GROVE, CA 92841 • 714.895.4344 • WWW.SENSOREX.COM

© Sensorex Corporation. All rights reserved. In the interest of improving and updating its equipment, Sensorex reserves the right to alter specifications to equipment at any time.