



for a greener tomorrow

# FR-D700 Series VFD

## Product Overview



FR-D700 is Mitsubishi Electric's class-leading range of micro drives. Suitable for a wide variety of general purpose motor speed control applications, the FR-D700 was built from the ground up using custom components and has earned an enviable reputation for durability and dependability in adverse environments.

### KEY BENEFITS:

- **Highly compact design** – Reduced installation footprint
- **5 Year warranty** – Extra peace of mind
- **Safety drive capability** – Eliminates the need for an extra contactor for operator safety
- **Built-in Modbus RTU communications** – Seamless integration into control systems
- **60:1 speed range** – Fast acceleration of high inertia loads
- **Bookshelf mounting capability** – Increased installation density allows smaller panel sizes
- **Built-in dynamic braking circuit** – Allows for simple installation of brake resistors for heavy deceleration
- **150% overload capability** – For dependable trip-free operation



## FR-D700 Series VFD – Product Overview

### 5 YEAR WARRANTY

Mitsubishi Electric's 5 Year micro drive warranty is our expression of confidence in the quality and durability of FR-D700 – and your peace of mind.



### SAFETY DRIVE

A special redundant circuit in FR-D700 allows the elimination of a dedicated emergency stop contactor, reducing installation cost and installation space.

The FR-D700 series is compliant to the EU Machinery Directive without the addition of previously required external devices. Operation of an external Emergency Stop device results in a highly reliable immediate shutoff of the D700's output to the motor. This safety stop function conforms to the following standards.

**EN954-1 (ISO13849-1) Category 3**

**IEC60204-1 Stop Category 0**

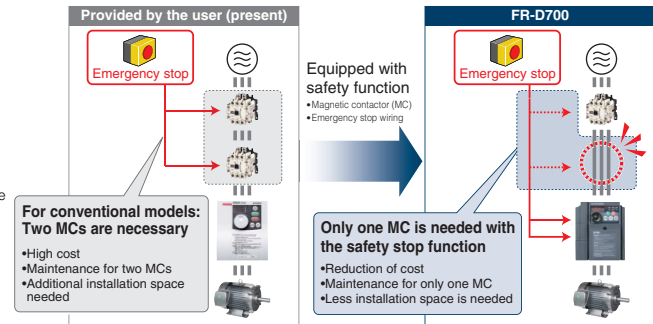

### BOOKSHELF MOUNTING

FR-D700 can be installed in a cabinet 'bookshelf style', reducing total installation space inside the control panel.



## MITSUBISHI ELECTRIC AUTOMATION, INC.

500 Corporate Woods Parkway, Vernon Hills, IL 60061  
Ph 847.478.2100 • Fx 847.478.2253

[us.MitsubishiElectric.com/fa/en](http://us.MitsubishiElectric.com/fa/en)

February, 2016 • ©2016, Mitsubishi Electric Automation, Inc.  
Specifications subject to change without notice. • All rights reserved

L-VH-04080  
F72-155-SLSMKTG-004-D